

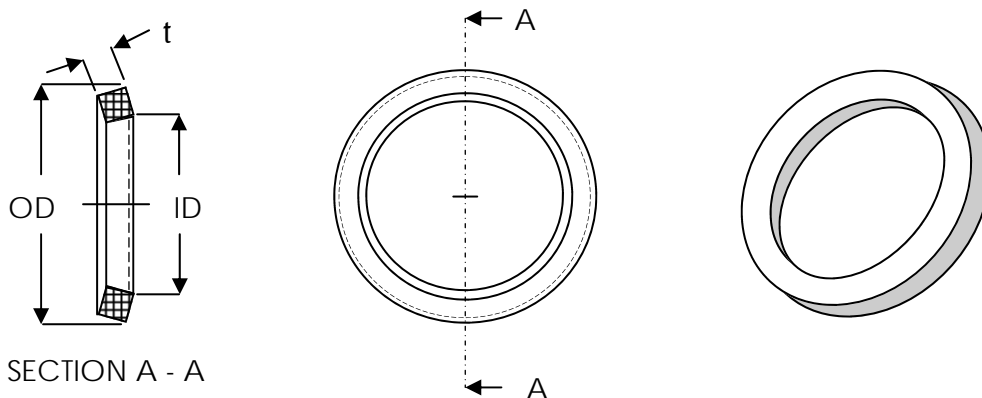

39 Souhegan Street - P.O. Box 269, Wilton, New Hampshire 03086
TEL (603) 654-2002 FAX (603) 654-2533
email: sales@shp-seals.com - website: www.shp-seals.com

ISO 9001:2008 Certified

**SOLDER PREFORMS
SMP & SMPM CONNECTORS**



These preforms are designed specifically for SMP & SMPM series connectors. They provide optimum flow and fillet when used with the recommended preform well and are available in the following solders: Sn63, Sn96 or Sb5 for RACPO & RACMPO series and 80/20 Au/Sn for the RKCPO series.

		DIMENSIONS ⁽²⁾		
CONNECTOR SERIES	PREFORM PART NO.	ID	OD	t
RACPO	SPPF-RACxx ⁽¹⁾⁽³⁾⁽⁵⁾	.171	.228	.027
RACMPO	SPPF-RACMxx ⁽¹⁾⁽³⁾	.133	.174	.039
RKCPO	SPPF-RKC8020 ⁽⁴⁾	.168	.108	.005

Example Part No. SPPF-RAC63

- NOTES: (1) Insert last 2 digits of desired solder in place of xx (63, 96 or b5).
(2) Tolerance on all dimensions is ±.002
(3) 80/20 solder only available on RKCPO series
(4) Available in 80/20 Au/Sn solder only
(5) Two preforms required for flush mount. Contact SHP for recommendation for other mount styles.

Solder Melting Temperatures

- Sn63 - 183°C (361°F)
- Sn96 - 221°C (430°F)
- Sb5 - 232-240°C (450-464°F)
- 80/20 - 280°C (536°F)

All dimensions are inches.