

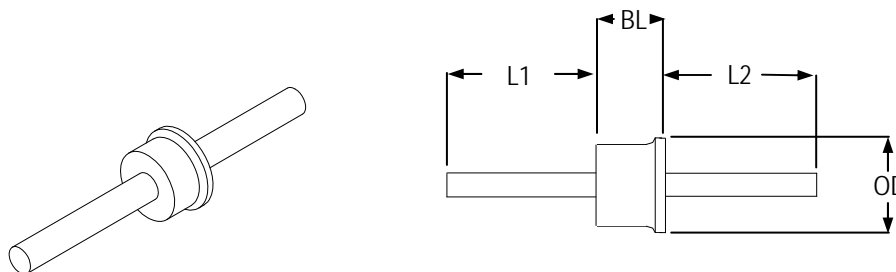

39 Souhegan Street - P.O. Box 269, Wilton, New Hampshire 03086
TEL (603) 654-2002 FAX (603) 654-2533
email: sales@shp-seals.com - website: www.shp-seals.com

HERMETIC GROUND PIN FEEDTHRU



ALUMINUM COMPATIBLE

These hermetic ground pins incorporate the same geometric features as our glass to metal seals, thereby facilitating an extremely high reliability solder joint for high expansion materials such as aluminum in severe thermal environments. The feedthru pin facilitates grounding of internal circuits. Radius pin termination is available for connector applications. Max leak rate 1 X 10^-8 cc/sec @ 1 atm (He).

Table with 9 columns: PART NO., OTHER DIMENSIONS, MATERIAL, SERIES, L1, L2, PLATING CODE, OD, BL, PIN DIA., FERRULE, PIN. Lists various part numbers like SHP1340G, SHP6020G, etc.

Example Part No: SHP74B20G-125-200-02

- NOTES: (1) Seals of any desired geometry can be provided. Contact us for your special requirements. (2) Standard plating - 50 microinches minimum GOLD per MIL-G-45204, Type III, Grade A over 200-400 microinches NICKEL per MIL-C-26074. Plating thickness is measured on pin. (3) Standard pin termination is straight-cut. Special pin terminations are also available (See Bulletin 100, Page 3). (4) See Bulletin 200 for solder preforms. (5) For application data see Bulletin 100, Page 2.

All dimensions are inches.